

**MWF Ned Lake, LLC - Michigan's Upper Peninsula
Ned Lake Unit - Compartment 16 - Aerial Map
Potential Land Sale - Spurr River**

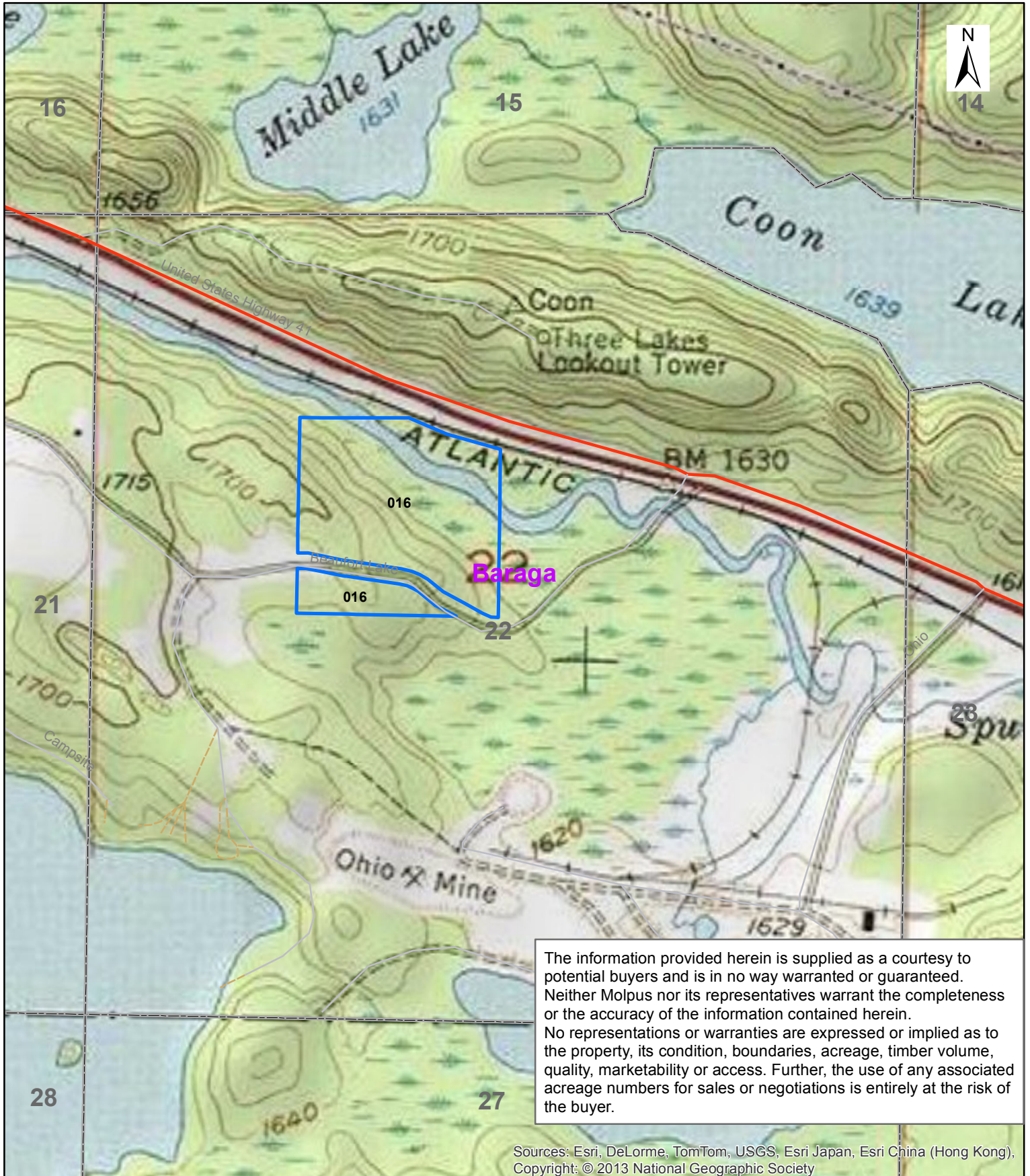

The information provided herein is supplied as a courtesy to potential buyers and is in no way warranted or guaranteed. Neither Molpus nor its representatives warrant the completeness or the accuracy of the information contained herein. No representations or warranties are expressed or implied as to the property, its condition, boundaries, acreage, timber volume, quality, marketability or access. Further, the use of any associated acreage numbers for sales or negotiations is entirely at the risk of the buyer.

Sources: Esri, DeLorme, TomTom, USGS, Esri Japan, Esri China (Hong Kong),
Copyright: © 2013 National Geographic Society

Baraga County, MI
T48N R31W Section 22
Part of SENW
+/-33.8 acres

Produced by Molpus Timberlands Management, GIS Dept. March 16, 2011.

